

# Field Effect Integration Setup

Set up the Field Effect integration with MSPbots using the guide below.

To connect Field Effect to MSPbots:

1. Create the Field Effect API Key.
  - a. Log in to [Field Effect](#).
  - b. Click the **Add new** button to create a new API key.
  - c. Enter a **Display Name** in the pop-up box and click **Next**.
  - d. Click **Copy to clipboard** to save the key locally.

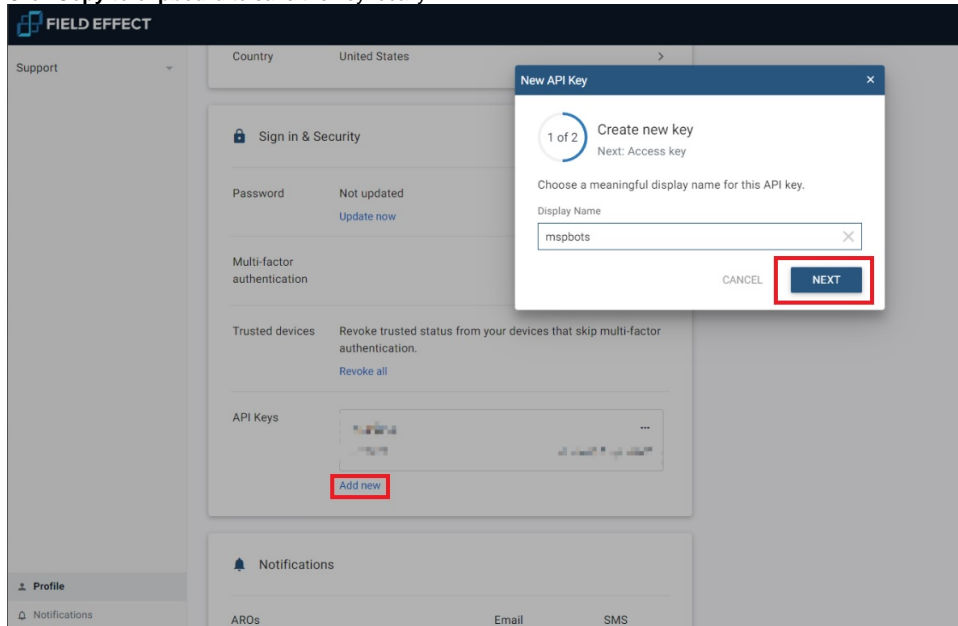

2. Next, go to the MSPbots app and navigate to [Integrations](#).
3. Find **Field Effect** and click it to open.

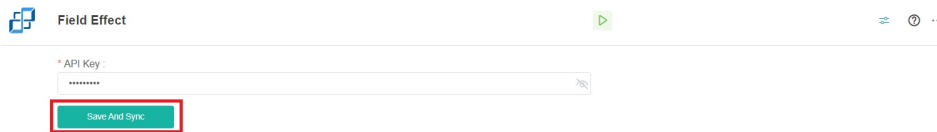

4. Enter the API Key, then click **Save And Sync**.